



## PC male thread straight-through pipe joint

### PC male thread straight-through pipe joint

Material: plastic socket: POM, imported sealing ring: stainless steel circlip, body: brass

Operating pressure range: 0-10kgf/cm<sup>2</sup>

Operating temperature range: -20~70°C

General hose: PU tube or nylon hose

Color: plastic socket: blue, body: brass (no plating)

1. Small appearance, saving installation space and high cost performance.
2. The threaded part is coated with sealant to ensure that there is no leakage in the threaded connection part.
3. The color of the plastic interface part is available in blue, white, and black to facilitate your overall piping needs.



PC male thread straight-through pipe joint

## Specification

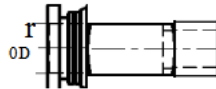

Item No.	OD	Connection thread/R	Package /PCS
PC4-M5	4	M5x0.8	100
PC4-01	4	PT1/8	100
PC4-02	4	PT1/4	100
PC4-03	4	PT3/8	100
PC4-04	4	PT1/2	100
PC6-M5	6	M5x0.8	100
PC6-01	6	PT1/8	100
PC6-02	6	PT1/4	100
PC6-03	6	PT3/8	100
PC6-04	6	PT1/2	100
PC8-01	8	PT1/8	100
PC8-02	8	PT1/4	100
PC8-03	8	PT3/8	100
PC8-04	8	PT1/2	100
PC10-01	10	PT1/8	100
PC10-02	10	PT1/4	100
PC10-03	10	PT3/8	100
PC10-04	10	PT1/2	100
PC12-01	12	PT1/8	100
PC12-02	12	PT1/4	100
PC12-03	12	PT3/8	100
PC12-04	12	PT1/2	100

## Product Show

# 零部件拆解，全方位解析

PARTS DISMANTLING, COMPREHENSIVE ANALYSIS

追求每个零件的完美统一

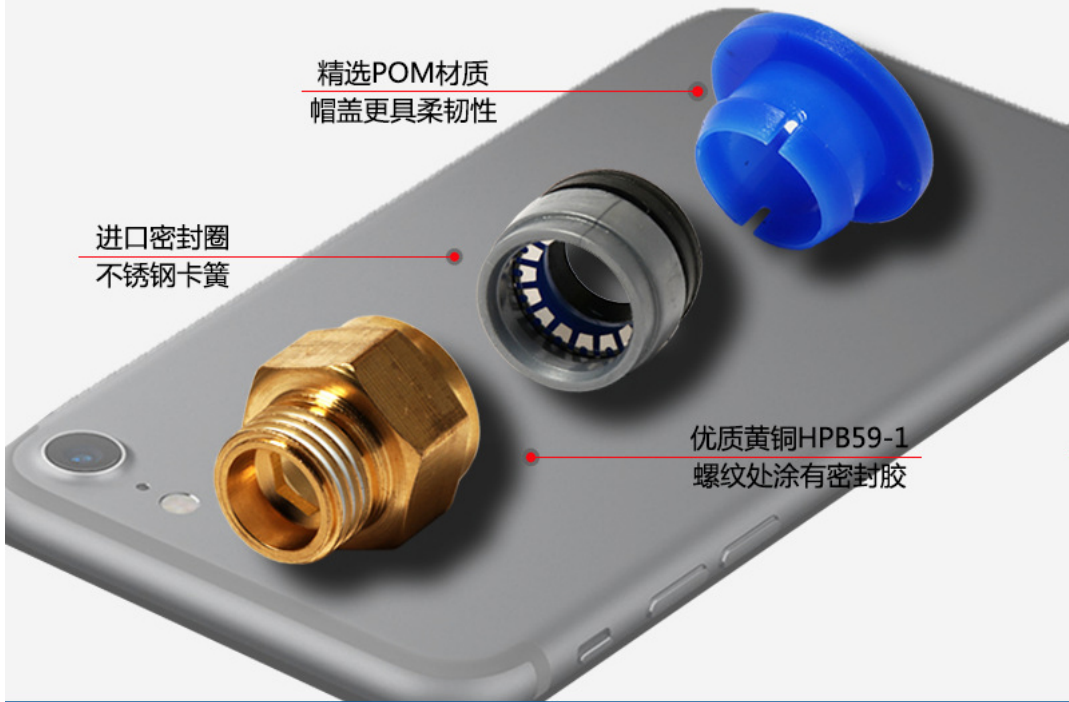

Push-in fittings

## 快插接头 PC外螺纹直通

- 耐高压
- 不脱扣
- 经久耐用
- 种类齐全



